

Public Detail with Addl Pics Report

Listings as of 05/12/18 at 8:28pm

Active 10/10/17 **Listing # 117780** **Woodland Rd, Taghkanic, NY 12521 Map** **Listing Price: \$48,500**
County: Columbia

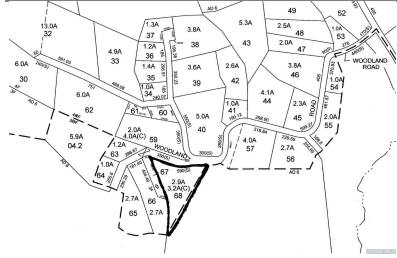

Property Type	Land		
Area	Taghkanic		
Tax Map ID	143.-1-68	Lot Sq Ft (approx)	126324
		Lot Acres (approx)	2.9000
DOM	215		



School District Taconic Hills

Directions From Craryville Route 23 West to Left on County Route 11. South on CR 11 for 0.7 miles to right on Woodland Rd. Property on left just prior to where the private road splits off to the left. Please do not use private roadway or neighbors driveway.

Marketing Remark Come see this building lot in the town of Taghkanic. The parcel is located in a rural area that is teeming with wildlife. The approximately three acre parcel is populated with mature hardwoods that will provide a private and secluded building site. Mostly flat land will result in site work ease and below average development costs. The parcel is accessed from a quiet, paved dead end road. If you are searching for your dream home site you need to take a look at this parcel.

Special Conditions	Other-See Comments (Letter of Administration)	Ag District	Yes
Flood Zone	Unknown	Lot Size	2.9 Acres
% Wooded	%100.00	Survey	Yes
Zoning	Ag/Res	Paved Street	Yes
Views	Local, Parklike, Wooded	Secluded	Yes
Road Frontage	590 feet	HOA	No
School Tax	\$462.41	Town Tax	\$360.10
Assessment	\$44800	Assessors FulMrktVal	\$41386.00
Tax Exemptions	No	Water	None
Sewer	Septic Needed	Electric	On Road

Presented By:

Margaret K Bower Avenia

Primary: 518-697-9865
 Secondary: 518-325-9784
 Other:
 Fax : 212-731-0210
 E-mail: MargaretAvenia@gmail.com

Web Page: <http://www.RealEstateColumbiaCounty.com>

Columbia County Real Estate Specialists, LLC

39 Tory Hill Road
 Hillsdale, NY 12529
 518-325-9784



May 2018

Featured properties may not be listed by the office/agent presenting this brochure.
 Information not guaranteed.

Copyright ©2018 Rapattoni Corporation. All rights reserved.
 U.S. Patent 6,910,045

